

Typical Clubstore Frame Package

Track & Groove features may be easily modified for UV adhesive application with the addition of Proud Point features.

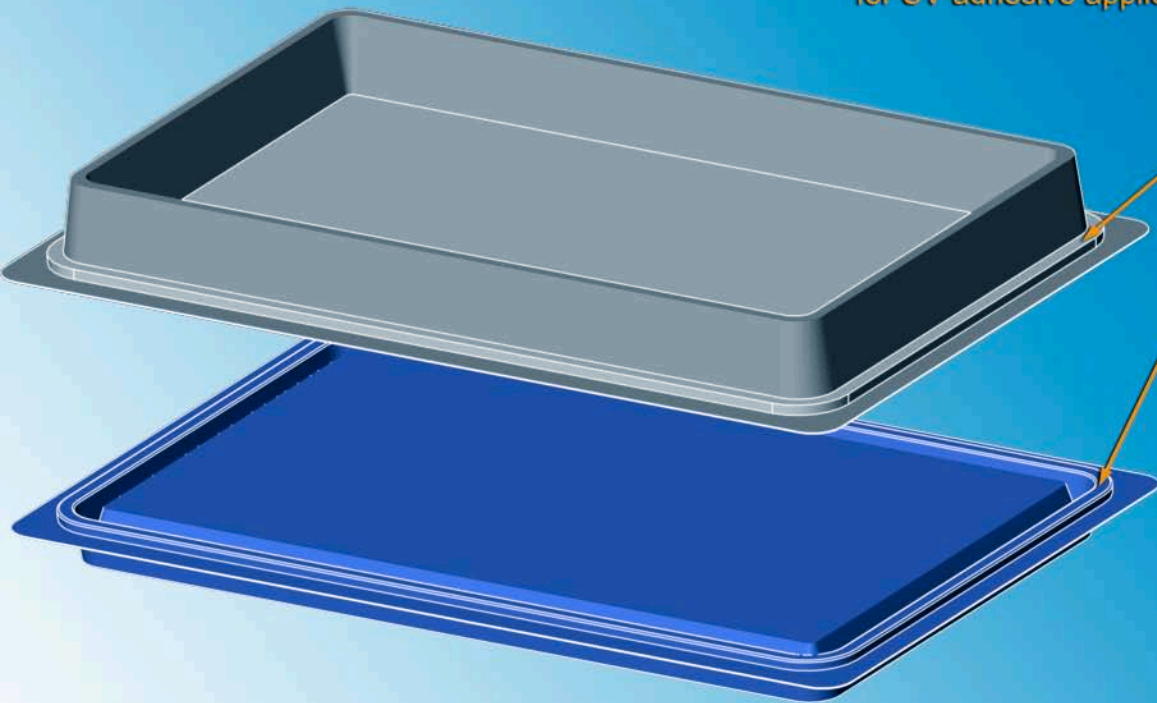

Cross Section:

Typical club store “frame style” configuration before addition of preferred Proud Point feature for use with *Simpl-Coater*

Top and Sidewalls of track & groove must have surface-to-surface contact.

Location for Proud Point feature addition.

Insert Card

Back surface must be lower than Proud Point surface.

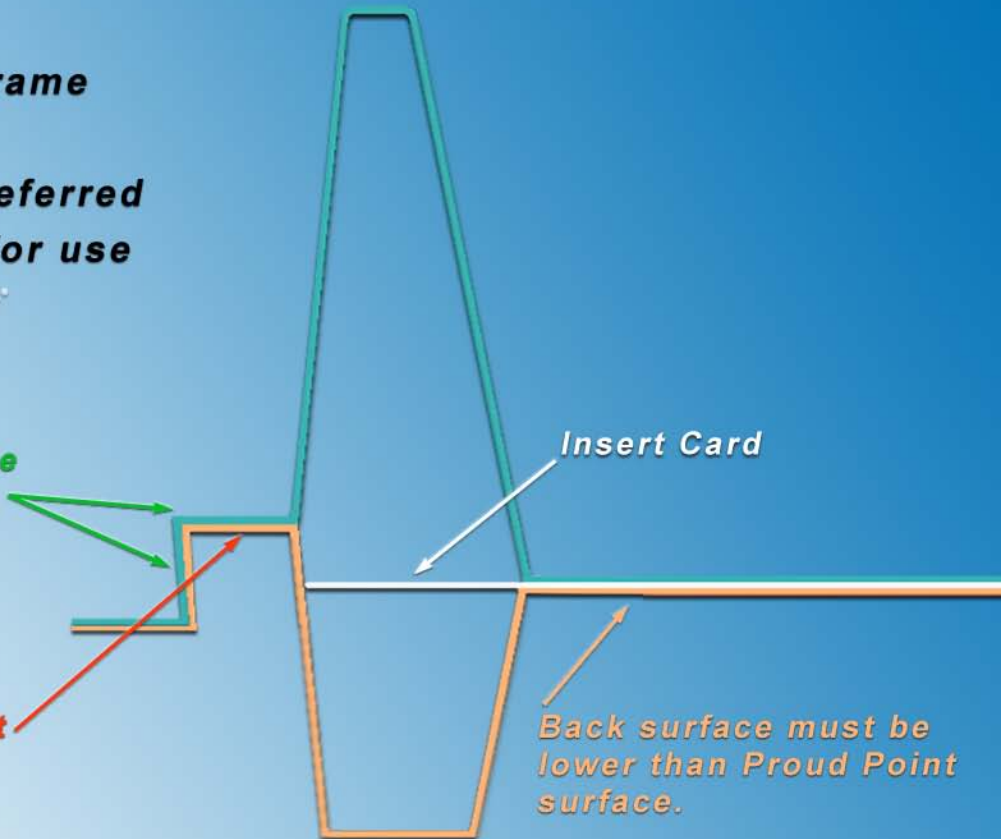

**Frame Style track & groove
with Proud Point feature.**

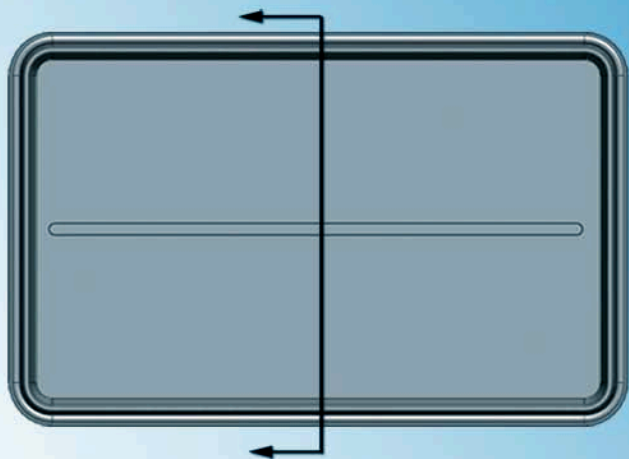

**Proud Point
features**



FRONT

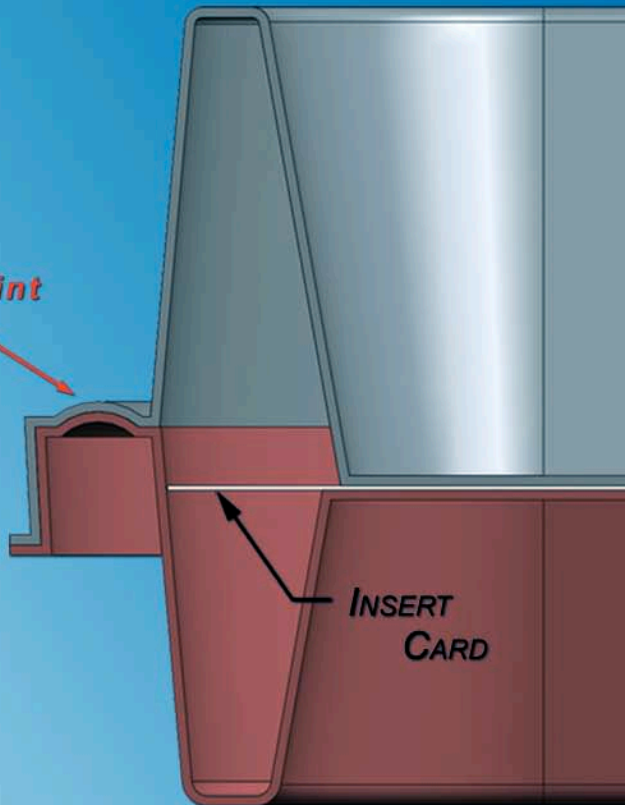

BACK

Proud Point (with flange shoulder) Configuration Comparison

***Does not promote even distribution
of UV adhesive to sidewalls and flange
shoulder.***



***Proud Point too tall
with full side radius.***

***Promotes hydraulic action to
evenly distribute UV adhesive
to sidewalls of Proud Point and
flats of flange shoulder.***



***Ideal Proud Point
Sidewall draft from
partial radius.
Radius is continuous
with no flats.***

Cross Section:

Proud Point & Shoulder Fit



Proud Point

Concentric Alignment

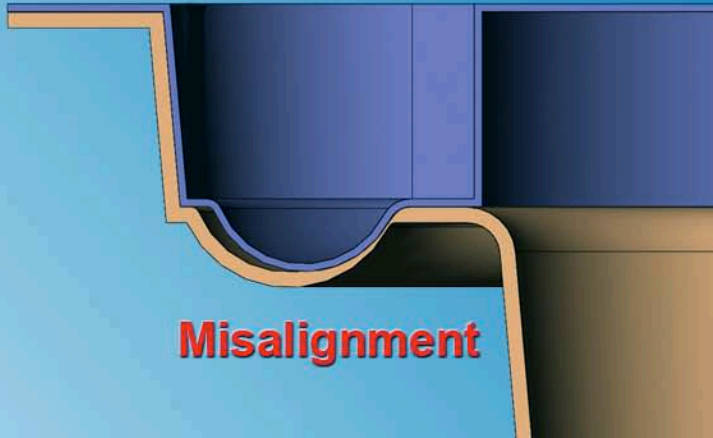
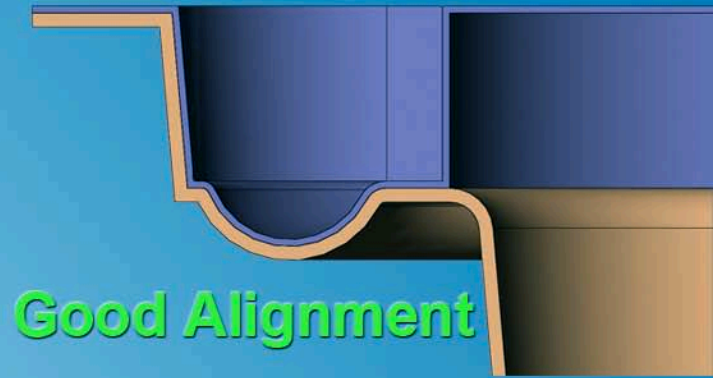

 **Simpl-Seal**

UV Adhesive - Hydraulic Dispersion

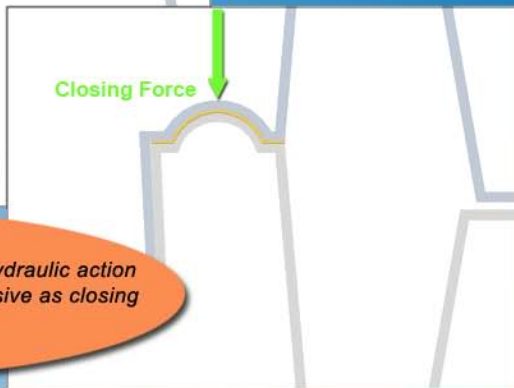
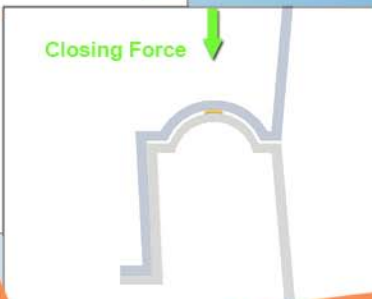
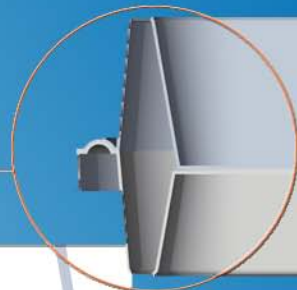
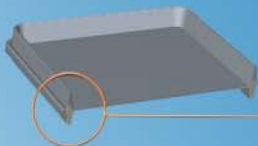
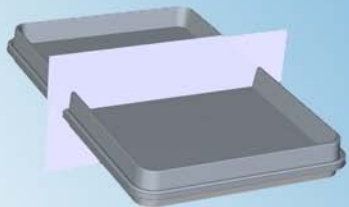

The Proud Point Mating Surface must be formed so that its feature surface is fully concentric to the Proud Point surface with no gaps or spaces.

This surface-to-surface contact promotes hydraulic action necessary to evenly distribute the UV adhesive as closing force is applied via the Roller Closer.

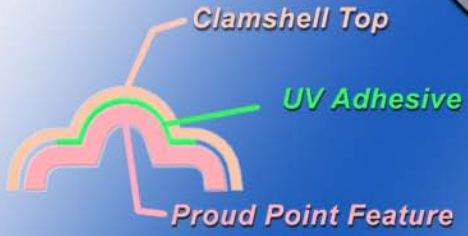
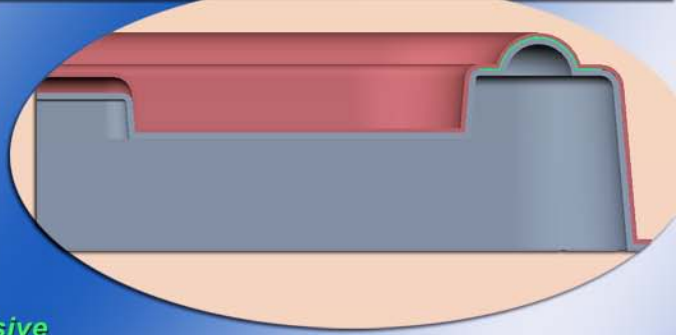



 **Simpl-Seal**

SEALING AT THE SPEED OF LIGHT



ck

eau de toilette
Calvin Klein

1.7 FL OZ 50 ml e

ck

eau de toilette
Calvin Klein

1.7 FL OZ 50 ml e

Mid-Line Clamshell

Design for high speed automated dispensing of UV adhesive with automatic clamshell closing and sealing.

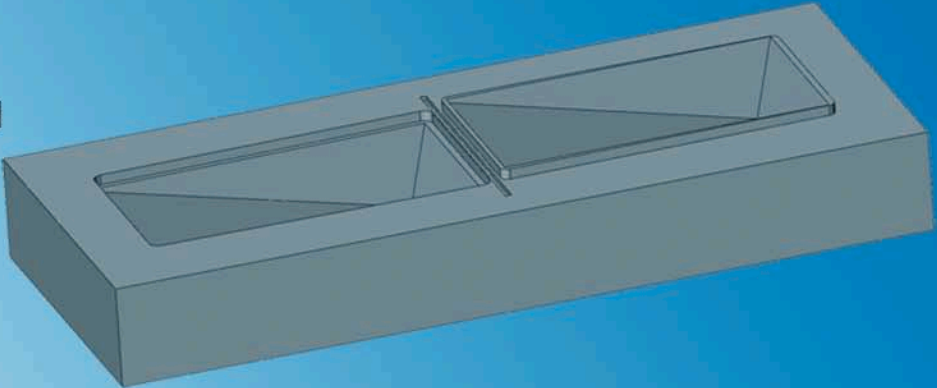

Sheet Line

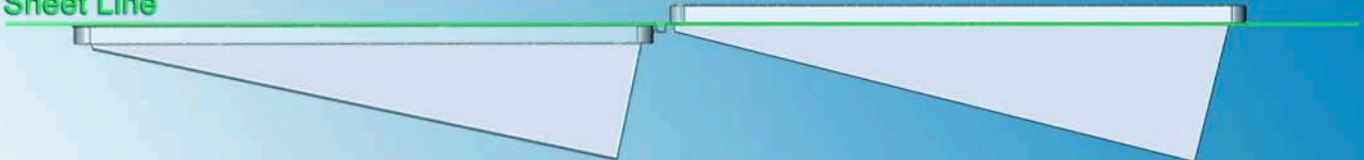

Proud Point (rim flange) must be level

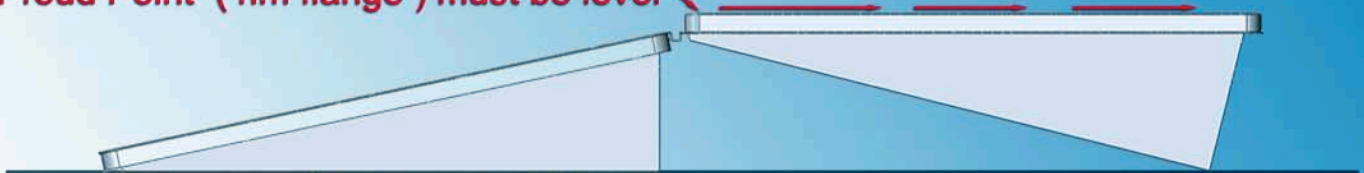

Clamshell Front Face

and Back bottom edge

must touch conveyor surface.

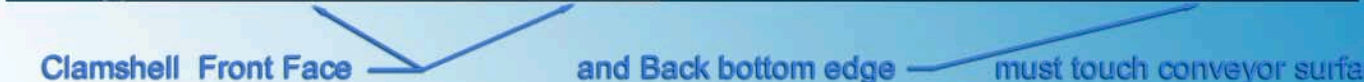

Tri-Fold Clamshell with *Simpl-Seal* PROUD POINT

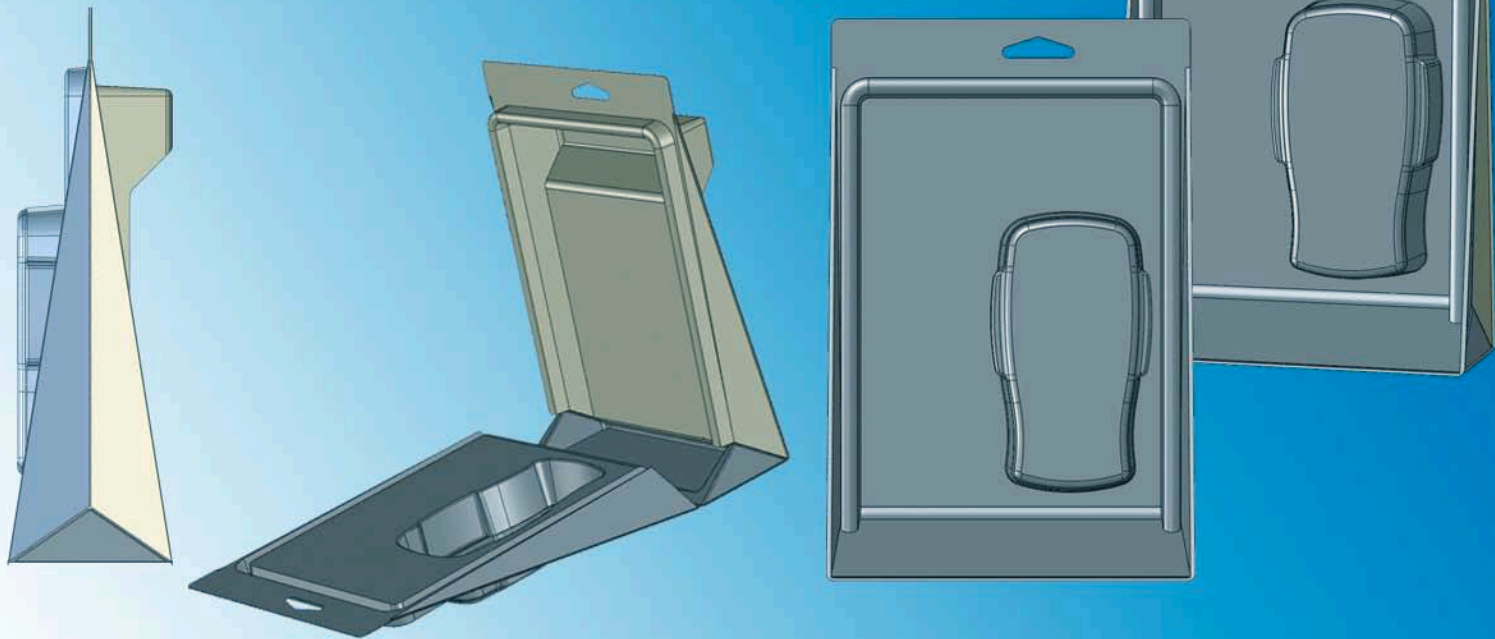

Tri-Fold Clamshell with Simpl-Seal[®] PROUD POINT

PROUD POINT must be above opposite half of clamshell and any product or insert cards.



Foot feature supports **PROUD POINT** for even application of UV adhesive.

Nested top and bottom **PROUD POINT** features may be back-drafted to lock into place.

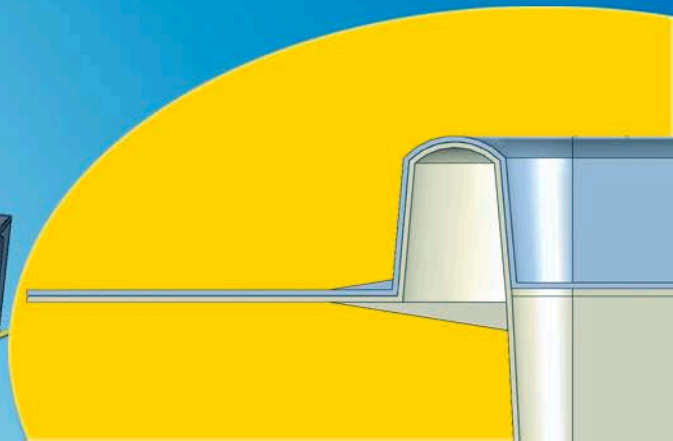
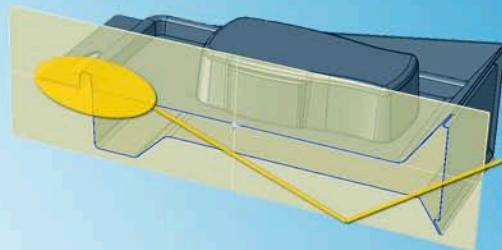

Hinged Clamshell

with *Simpl-Seal* PROUD POINT

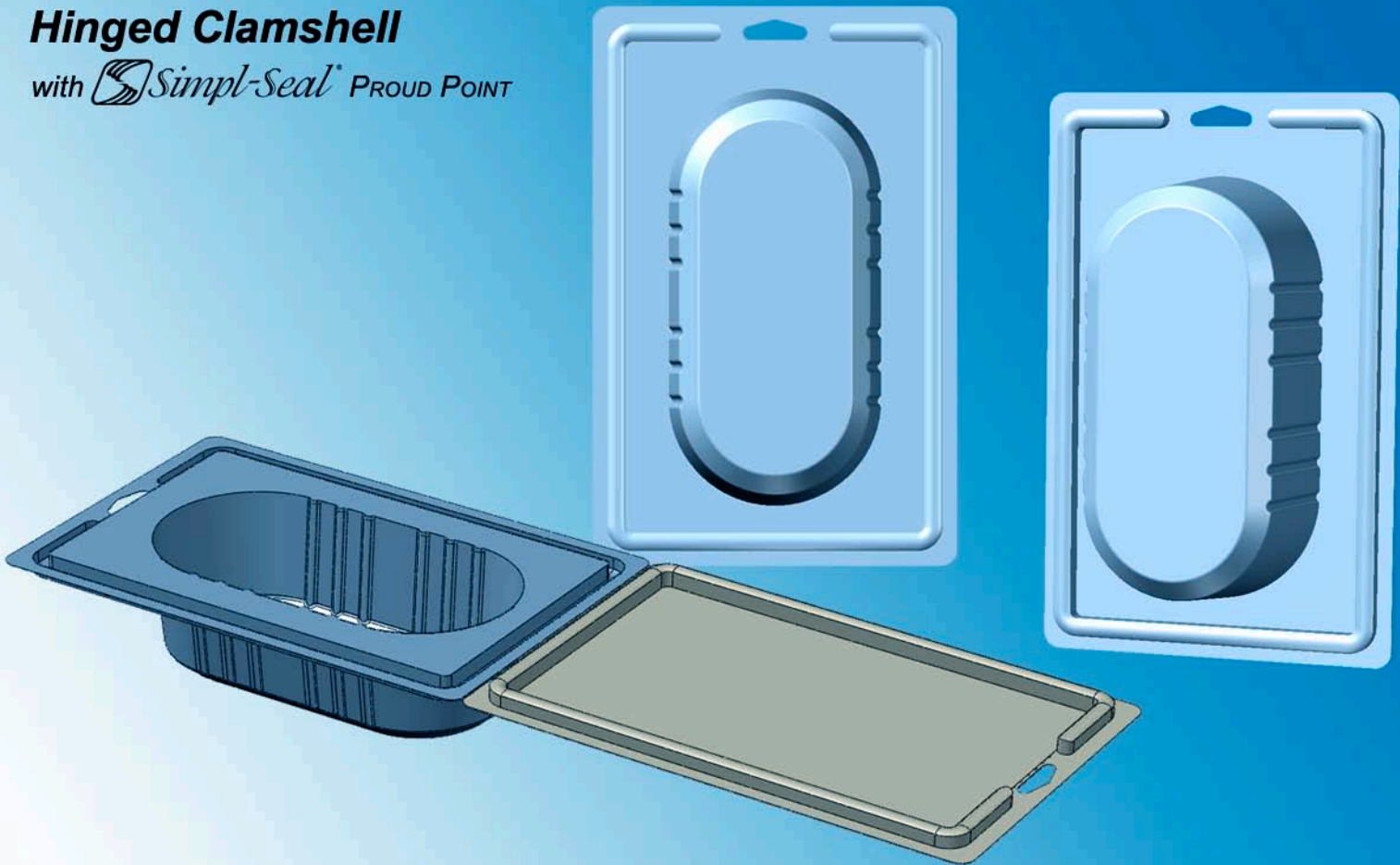

Hi-Speed Work Center

Adjustable tandem conveyor belt system allows clamshells to straddle pocket features for maximum throughput using the *Simpl-Seal* system to automate application of UV adhesive, product placement and package closing.

Air Knife Station

Burst of air throws lid over into place to be closed by Roll Closer bar.

Top Coater

Applies *Simpl-Sealant* to the *PROUD POINT* of the package.

CONVEYOR LINE FLOW